

Rubber-Expansion-Joint Type 130 O

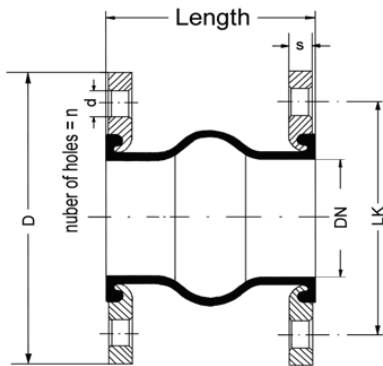

Operating pressure: at 20° up to 16 bar, on 110°C up to 10 bar.

Construction: highly flexible rubber bellows with flat convolution
Core/Cover = EPDM Reinforced with Nyloncord



DN	BL	+ axial	- axial	+/- lateral	angular
25	130	9	13	14	15°
32	130	12	20	14	15°
40	130	12	20	14	15°
50	130	12	20	14	15°
65	130	12	20	14	15°
80	130	12	20	14	15°
100	130	12	20	14	15°
125	130	12	20	14	15°
150	130	12	20	14	15°
200	130	12	25	14	15°
250	130	16	25	22	15°
300	130	16	25	22	15°
350	203	16	25	22	15°
400	203	16	25	22	15°
500	203	16	25	22	15°
600	270	16	25	22	15°

Flanges:

Loose Flanges made of RSt 37-2 galvanized yellow plated, drilled according to DIN 2501 PN 10 or 16

Oval Loose Flanges made of RSt 37-2 galvanized yellow plated, drilled according to DIN 2501 PN 10 or 16, with rubber coated tie bars for best noise absorption.

Flange dirlings: PN 6 , PN 10 , PN 16, PN 25 , ASA 150 LBS

Flange materials: RSt 37-2 (AISI C1010), 1.4541 (AISI 321), 1.4571 (AISI 316 Ti), plastic, Aluminium and others. If nessesary, the flanges can be coated with other materials as well.